



Keybridge House

2 Exchange Gardens, Nine Elms, SW8 1DF

Asking Price £550,000



Floor Plan

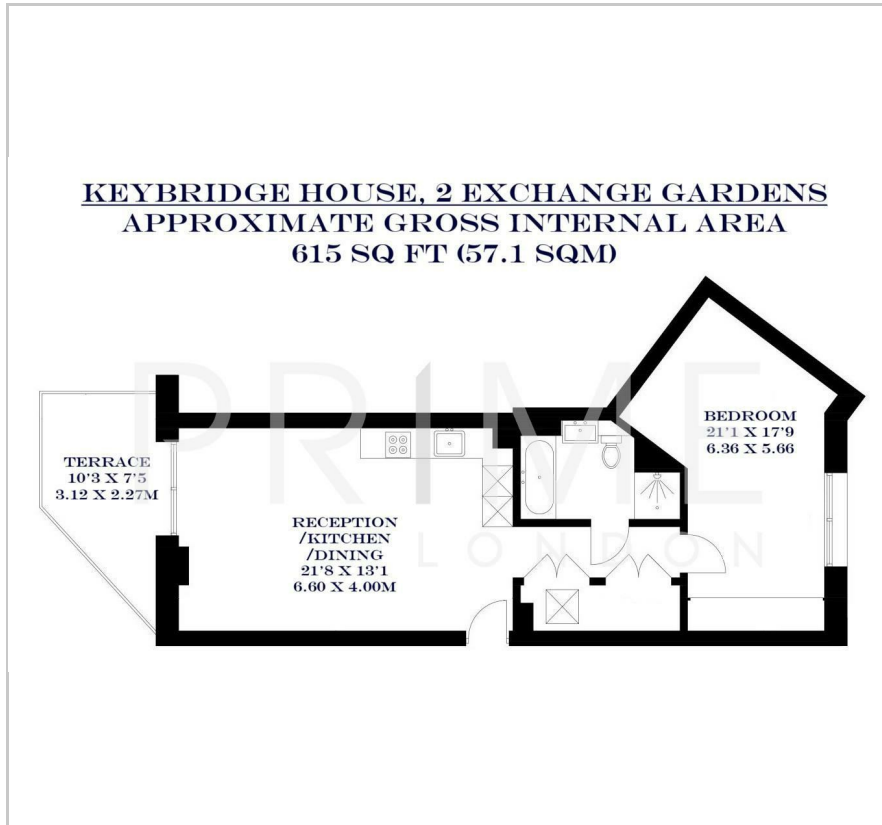

Area Map

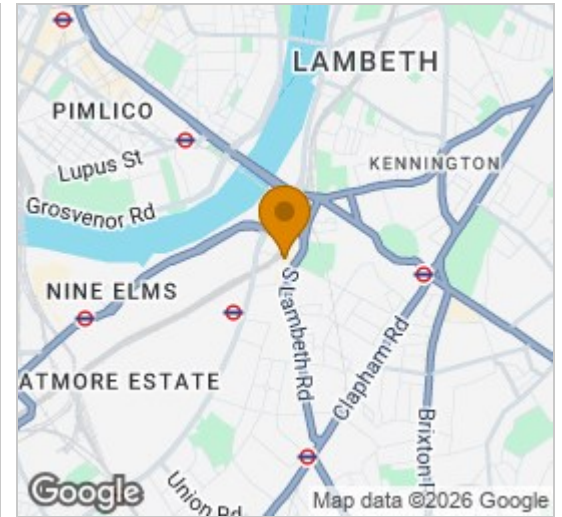

Energy Efficiency Graph



Viewing

By appointment. Contact us on 0207 928 6663 if you wish to arrange a viewing appointment for this property, or require further information.

- Stunning one bedroom ▪ 615 sq ft (57.1 sqm) apartment
- Private terrace
- Residents' Club Lounge
- 24 hour concierge service
- Gym, pool, spa, sauna and steam room

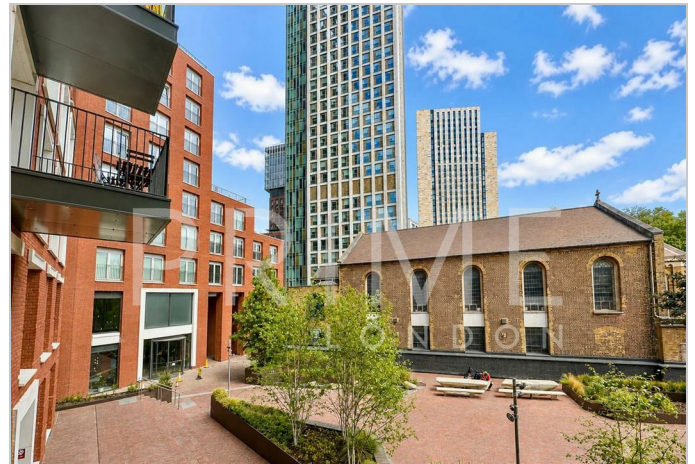

This beautifully designed one bedroom apartment showcases the distinctive warehouse style of the highly sought after Keybridge development, and is available for chain free sale through Prime London.

Extending to 615 sq ft (57.1 sqm), the property offers a spacious open plan reception with a sleek, fully integrated kitchen, a generous double bedroom with excellent storage, and a contemporary luxury bathroom. A private terrace further enhances the living space.

Finished to an excellent standard throughout, the apartment is well proportioned, thoughtfully designed, and benefits from comfort cooling.

Residents benefit from 24 hour concierge, CCTV, secure cycle storage and audio-visual entry. Access is also available to the residents' lounge, gym, swimming pool, sauna and steam room.

Ideally located in Zone 1, the apartment is just 0.3 miles from Vauxhall Underground and Rail Station, providing excellent connections to The City, Westminster and the West End. Vauxhall has become one of London's fastest growing neighbourhoods, with a wide range of restaurants, bars and local amenities nearby.



These particulars, whilst believed to be accurate are set out as a general outline only for guidance and do not constitute any part of an offer or contract. Intending purchasers should not rely on them as statements of representation of fact, but must satisfy themselves by inspection or otherwise as to their accuracy. No person in this firm's employment has the authority to make or give any representation or warranty in respect of the property.